



18 Old Oak Common Lane
Acton
London
W3 7EL
T 020 8749 9798
E sales@churchillmathesons.com
www.churchillmathesons.com

Churchill & Mathesons

Cotton Avenue, London, W3 6YG

£346 Per Month



KEY FEATURES:

- 1 Bedroom top floor flat in purpose built development
- Open plan kitchen
- Fully tiled bathroom
- FURNISHED ~ AVAILABLE 7th of January 2025
- Ealing Council, Council Tax band C
- EPC Rating: C

Cosy 1 bedroom flat in purpose built development (Zone 2, Central Line)
* Spacious double bedroom
* Open plan reception room
* Fully fitted kitchen
* Partly tiled bathroom
* Offered in good condition
* Allocated parking
* Within 10 mins to North Acton tube station and its local amenities
FURNISHED ~ AVAILABLE 7th of January 2025
Ealing Council, Council Tax band C
EPC Rating: C

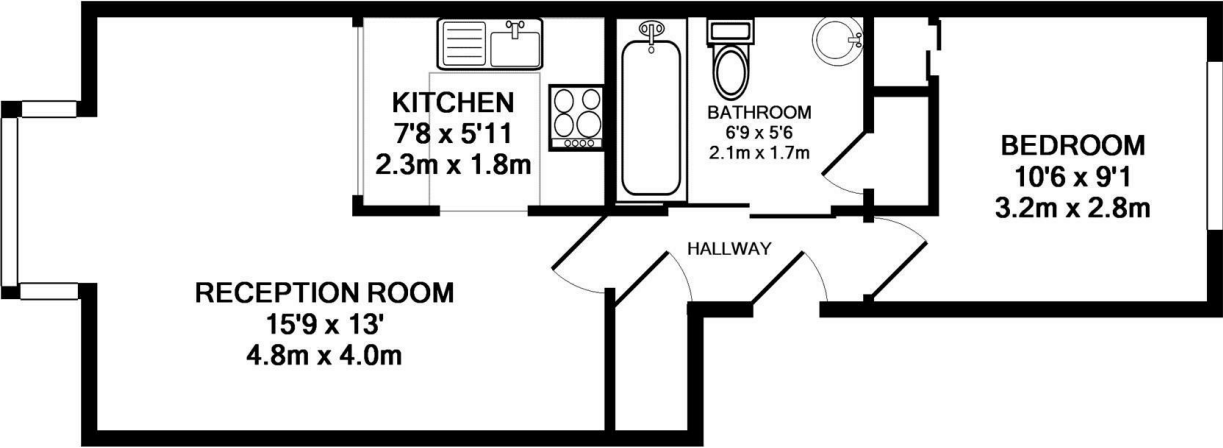

TOTAL APPROX. FLOOR AREA 36.7 SQ.M. (395 SQ.FT.)

Whilst every attempt has been made to ensure the accuracy of the floor plan contained here, measurements of doors, windows, rooms and any other items are approximate and no responsibility is taken for any error, omission, or mis-statement. This plan is for illustrative purposes only and should be used as such by any prospective purchaser. The services, systems and appliances shown have not been tested and no guarantee as to their operability or efficiency can be given
Made with Metropix ©2007



Energy Efficiency Rating

	Current	Potential
Very energy efficient - lower running costs		
(92 plus) A		
(81-91) B		
(69-80) C		
(55-68) D		
(39-54) E		
(21-38) F		
(1-20) G		
Not energy efficient - higher running costs		
England & Wales	EU Directive 2002/91/EC	EU Directive 2002/91/EC

Environmental Impact (CO₂) Rating

	Current	Potential
Very environmentally friendly - lower CO ₂ emissions		
(92 plus) A		
(81-91) B		
(69-80) C		
(55-68) D		
(39-54) E		
(21-38) F		
(1-20) G		
Not environmentally friendly - higher CO ₂ emissions		
England & Wales	EU Directive 2002/91/EC	EU Directive 2002/91/EC

Whilst every effort is made to give a fair description, the accuracy of these particulars is not guaranteed, neither do they constitute an offer or contract.

CHURCHILL & MATHESONS ESTATE AGENTS have not tested any apparatus, equipment, fitting or services and so cannot verify that they are in working order. The buyer is advised to obtain verification from their solicitor or surveyor. Measurements are correct to within +/- 6 A sonic tape is used. None of the statements contained in these particulars or any of our properties are to be relied upon as a representation of fact.